

2022  
**BURLINGTON STREET  
 ROADWAY IMPROVEMENTS  
 RALSTON, NEBRASKA**

**ROW 1B**

**PRELIMINARY**  
 NOT FOR CONSTRUCTION  
 0%  
 DATE: 3/27/2023  
**PRELIMINARY**

PROJECT NO.		PROJECT NO.
DATE	3/27/2023	
DRAWN BY	DRAWN BY	
FILE NAME	S_181714-19-ROW-1B.dwg	
FIELD BOOK	FIELD BOOK	
FIELD CREW	FIELD CREW	
SURVEY FILE NO.	SURVEY FILE #	
PLAN IN HAND	INTLS	PIH INI
	DATE	PIH DATE
70 PERCENT REVIEW	INTLS	70% INI
	DATE	70% DATE
95 PERCENT REVIEW	INTLS	95% INI
	DATE	95% DATE
REVISIONS		

**ROW**

**LEGEND**

LIMITS OF CONSTRUCTION	
PREVIOUS R.O.W.	
NEW R.O.W.	
EXISTING PERMANENT EASEMENT	
TEMPORARY EASEMENT	
EXCESS TAKING	
PERMANENT EASEMENT	

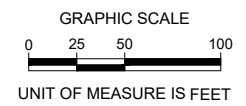

P:\181714-19-181714-19-ROW-1B.dwg on 3/27/2023 11:39 AM

**OWNERSHIP RECORD**

TRACT NO.	OWNER	DESCRIPTION	TOTAL AREA OWNED	TOTAL TAKING	NEW TAKING	EXCESS TAKING	PERMANENT EASEMENT	TEMPORARY EASEMENT	TRACT NO.
1	BURLINGTON INVESTMENT LLC						2,803 SQ. FT.	6,430 SQ. FT.	1
2	UNITED SEED INC.			23,780 SQ. FT.	23,780 SQ. FT.			420 SQ. FT.	2
3	OZVP VI LLC			1,993 SQ. FT.	1,993 SQ. FT.				3
4	RALSTON ECONOMIC DEVELOPMENT			14,924 SQ. FT.	14,924 SQ. FT.			2,471 SQ. FT.	4
5	DUDLEY'S MOVING AND STORAGE			1,664 SQ. FT.	1,664 SQ. FT.			155 SQ. FT.	5
6	K&M REALITY LLC			29,453 SQ. FT.	29,453 SQ. FT.			11,612 SQ. FT.	6
7	CITY OF RALSTON			2,814 SQ. FT.	2,814 SQ. FT.			2,092 SQ. FT.	7
8	CITY OF RALSTON							4,278 SQ. FT.	8
9	MARIA'S RESTAURANT							1,012 SQ. FT.	9





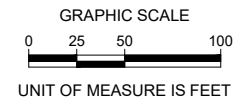
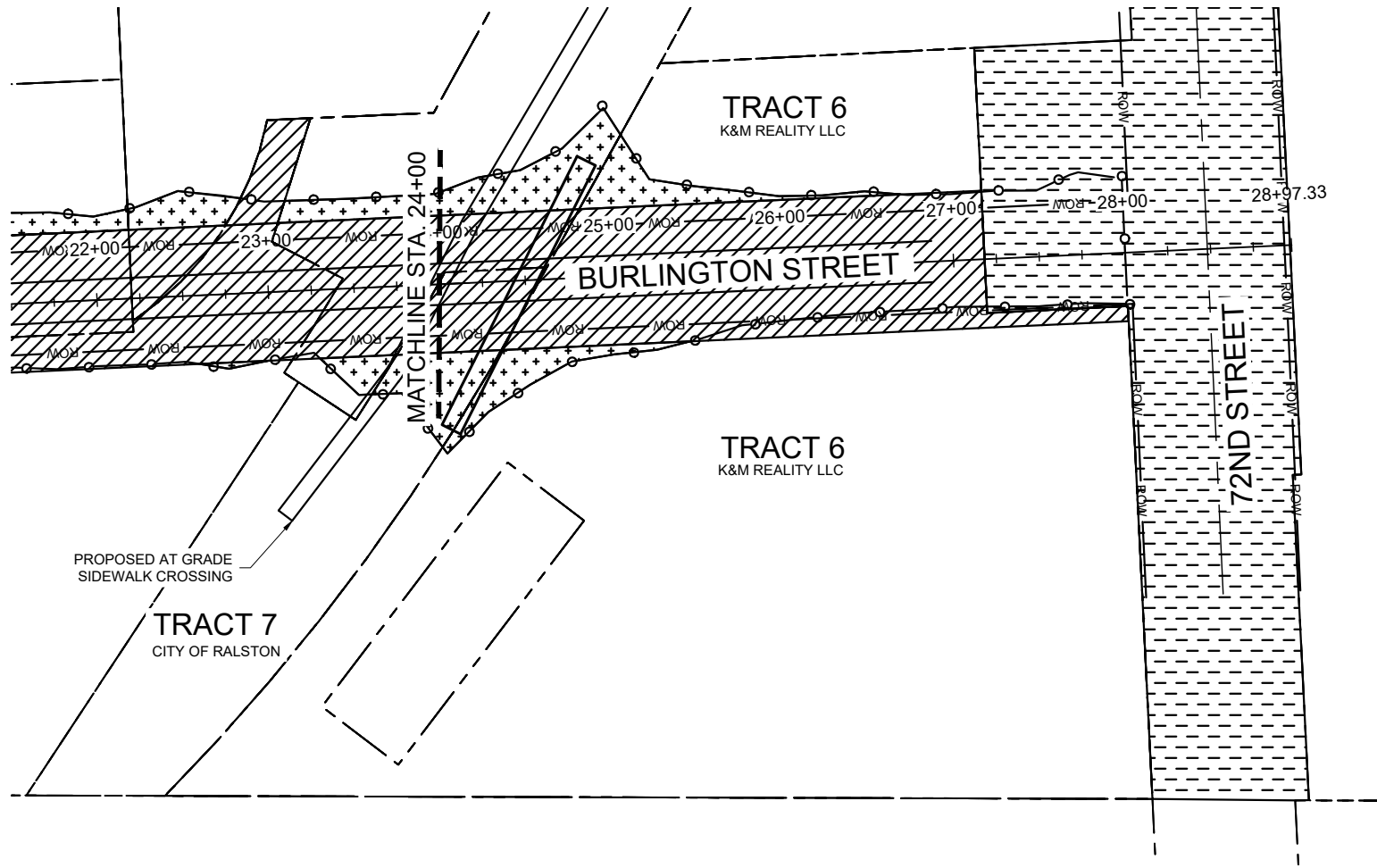

Know what's below.  
Call before you dig.

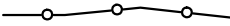
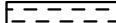

2022  
 BURLINGTON STREET  
 ROADWAY IMPROVEMENTS  
 RALSTON, NEBRASKA

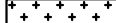
**LEGEND**

- LIMITS OF CONSTRUCTION 
- PREVIOUS R.O.W. 
- NEW R.O.W. 
- EXISTING PERMANENT EASEMENT 
- TEMPORARY EASEMENT 
- EXCESS TAKING 
- PERMANENT EASEMENT 

ROW 1B  
 PRELIMINARY  
 PRELIMINARY  
 PRELIMINARY  
 PRELIMINARY  
 NOT FOR CONSTRUCTION  
 0%  
 DATE:  
 3/27/2023

PROJECT NO.	PROJECT NO.
DATE	3/27/2023
DRAWN BY	DRAWN BY
FILE NAME	S_181714_19-ROW-1B.dwg
FIELD BOOK	FIELD BOOK
FIELD CREW	FIELD CREW
SURVEY FILE NO.	SURVEY FILE #
PLAN IN HAND	PIH INI
DATE	PIH DATE
70 PERCENT REVIEW	70% INI
DATE	70% DATE
95 PERCENT REVIEW	95% INI
DATE	95% DATE
REVISIONS	



Know what's below.  
Call before you dig.

ROW (2)

P:\planning\181714\_B - Ralston Burlington Street (ElectronicOriginal Layout)\Design\DWG\19-ROW-1B.dwg on 3/27/2023 11:39 AM

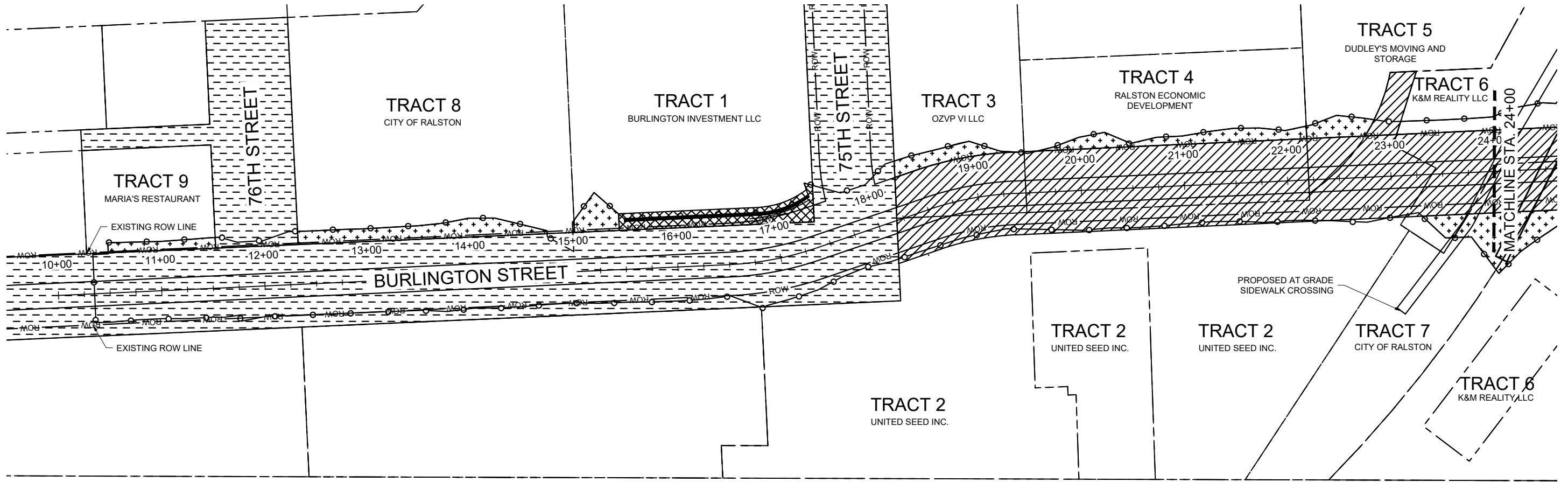





2022  
**BURLINGTON STREET  
 ROADWAY IMPROVEMENTS  
 RALSTON, NEBRASKA**

**ROW 2B**  
 PRELIMINARY  
 NOT FOR  
 CONSTRUCTION  
 0%  
 DATE:  
 3/27/2023  
 PRELIMINARY

PROJECT NO. PROJECT NO.  
 DATE 3/27/2023  
 DRAWN BY DRAWN BY  
 FILE NAME S\_181714\_19-ROW-2B.dwg  
 FIELD BOOK FIELD BOOK  
 FIELD CREW FIELD CREW  
 SURVEY FILE NO. SURVEY FILE #  
 PLAN IN HAND  
 INITIALS PIH INI  
 DATE PIH DATE  
 70 PERCENT REVIEW 70% INI  
 INITIALS DATE 70% DATE  
 95 PERCENT REVIEW 95% INI  
 INITIALS DATE 95% DATE  
 REVISIONS

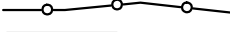
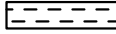
**ROW**

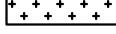
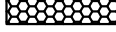
**LEGEND**

- LIMITS OF CONSTRUCTION 
- PREVIOUS R.O.W. 
- NEW R.O.W. 
- EXISTING PERMANENT EASEMENT 
- TEMPORARY EASEMENT 
- EXCESS TAKING 
- PERMANENT EASEMENT 

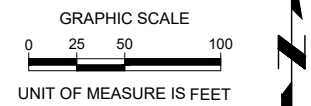

P:\181714\_19\181714\_19-ROW-2B.dwg 3/27/2023 11:58 AM

**OWNERSHIP RECORD**

TRACT NO.	OWNER	DESCRIPTION	TOTAL AREA OWNED	TOTAL TAKING	NEW TAKING	EXCESS TAKING	PERMANENT EASEMENT	TEMPORARY EASEMENT	TRACT NO.
1	BURLINGTON INVESTMENT LLC						3,426 SQ. FT.	1,119 SQ. FT.	1
2	UNITED SEED INC.			17,411 SQ. FT.	17,411 SQ. FT.				2
3	OZVP VI LLC			6,663 SQ. FT.	6,663 SQ. FT.			1,326 SQ. FT.	3
4	RALSTON ECONOMIC DEVELOPMENT			16,214 SQ. FT.	16,214 SQ. FT.			2,454 SQ. FT.	4
5	DUDLEY'S MOVING AND STORAGE			1,712 SQ. FT.	1,712 SQ. FT.			1,082 SQ. FT.	5
6	K&M REALITY LLC			32,312 SQ. FT.	32,312 SQ. FT.			7,982 SQ. FT.	6
7	CITY OF RALSTON			2,822 SQ. FT.	2,822 SQ. FT.			2,092 SQ. FT.	7
8	CITY OF RALSTON							3,185 SQ. FT.	8
9	MARIA'S RESTAURANT							981 SQ. FT.	9



Know what's below.  
 Call before you dig.

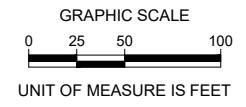
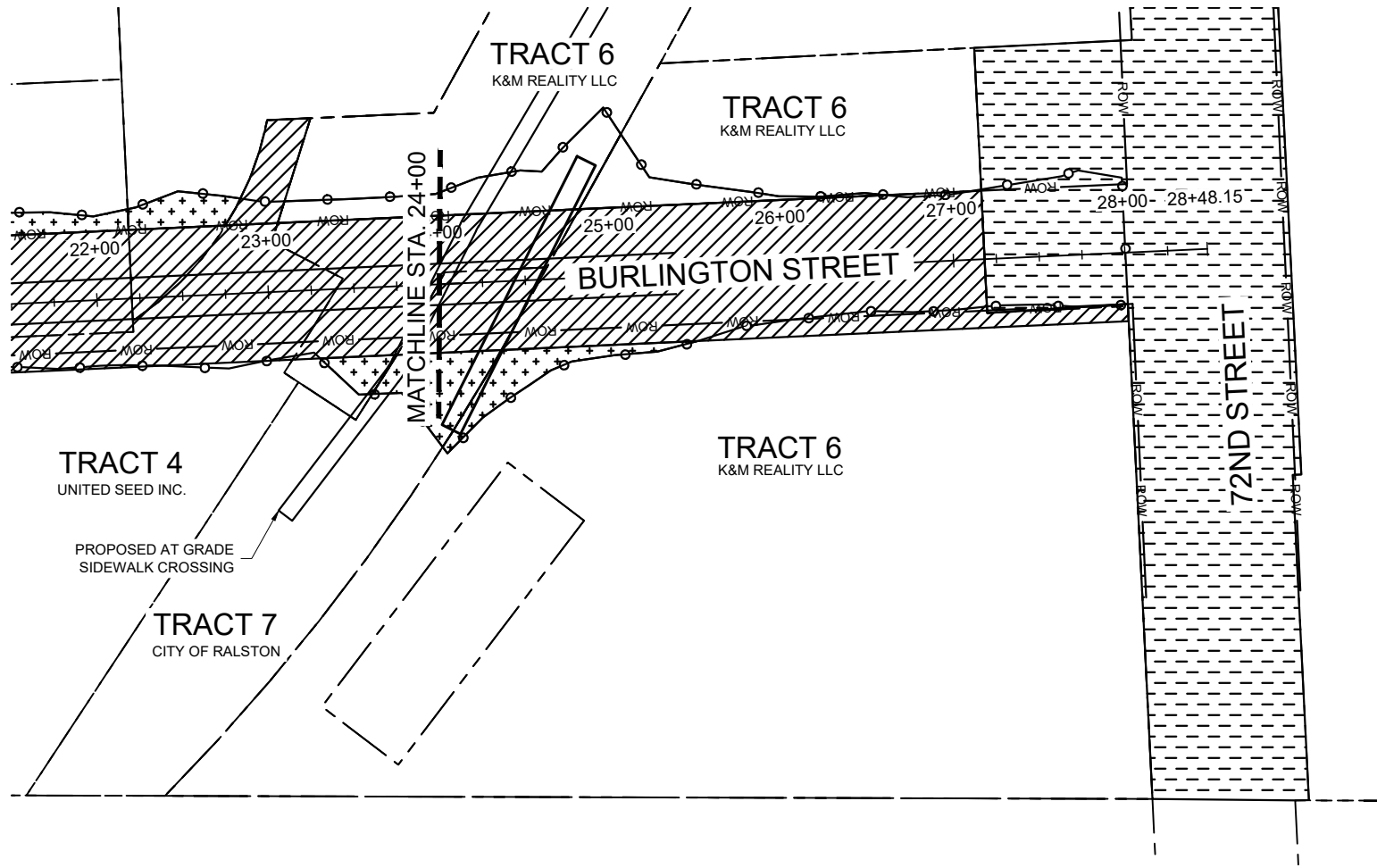

2022  
BURLINGTON STREET  
ROADWAY IMPROVEMENTS  
RALSTON, NEBRASKA

ROW 2B

PRELIMINARY PRELIMINARY  
NOT FOR CONSTRUCTION  
0%  
DATE: 3/27/2023

PROJECT NO.	PROJECT NO.
DATE	3/27/2023
DRAWN BY	DRAWN BY
FILE NAME	S_181714_19-ROW-2B.dwg
FIELD BOOK	FIELD BOOK
FIELD CREW	FIELD CREW
SURVEY FILE NO.	SURVEY FILE #
PLAN IN HAND	PIH INI
DATE	PIH DATE
70 PERCENT REVIEW	70% INI
DATE	70% DATE
95 PERCENT REVIEW	95% INI
DATE	95% DATE
REVISIONS	

ROW (2)

**LEGEND**

- LIMITS OF CONSTRUCTION
- PREVIOUS R.O.W.
- NEW R.O.W.
- EXISTING PERMANENT EASEMENT
- TEMPORARY EASEMENT
- EXCESS TAKING
- PERMANENT EASEMENT

P:\p\p\p\181714\_19 - Ralston Burlington Street (Electronic) - 181714\_19-ROW-2B.dwg on 3/27/2023 11:39 AM



Know what's below.  
Call before you dig.